

INSTALLATION INSTRUCTIONS

WALL-MOUNT SOAP DISPENSER

壁式擠皂罐組安裝說明

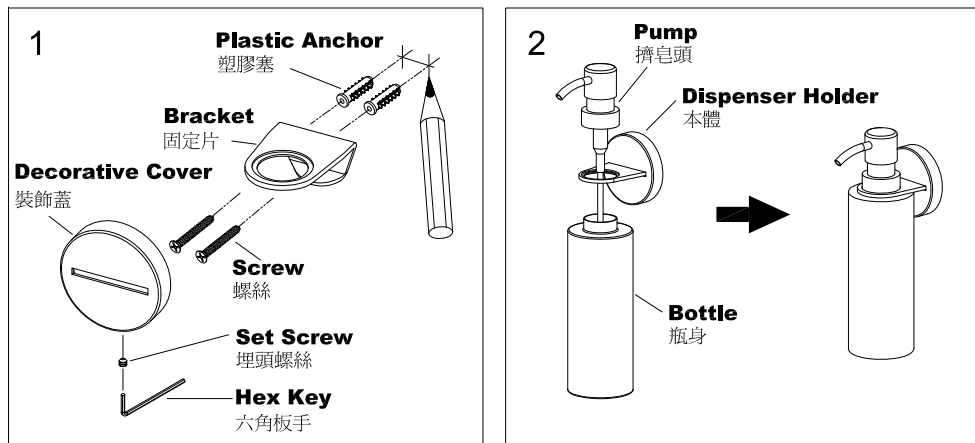

1. Select proper position for product and mark center of mounting hole on wall.
請先選取預定安裝的位置,並在牆壁上畫上預定鑽孔記號。
2. Using a 6mm drill-bit, drill the holes in marked position to a depth of 4cm. Insert the **Plastic Anchors** into the holes on the wall, put the **Screw(s)** through the **Bracket(s)**, then screw into the **Plastic Anchors**.
當安裝在水泥牆,使用1/4英寸鑽頭,鑽孔深度4公分,嵌入塑膠塞並使之齊平於牆面,將固定基座以螺絲鎖緊在牆上。
3. Use the **Hex Key** to loosen the **Set Screw** in the **Decorative Cover**. Slide the **Decorative Cover** over the **Bracket** and tighten **Set Screw** ensuring the orientation of the **Decorative Cover** is correct.
用隨附六角扳手先鬆開裝飾板下方的埋頭螺絲,使固定片能順利套進裝飾板後,再鎖緊下方的埋頭螺絲。
4. Assemble the Soap Dispenser as fig.2 shown.
將瓶身及擠皂頭結合於本體,完成安裝程序。

FIXING CONTENTS

組配件內容

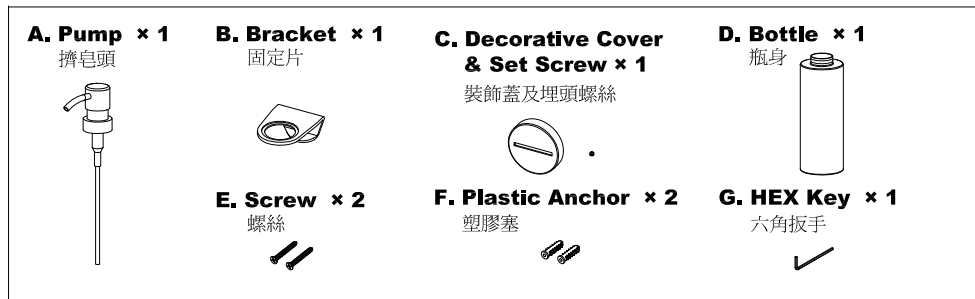

INSTALLATION INSTRUCTIONS

WALL-MOUNT SOAP DISPENSER

壁式擠皂罐組安裝說明

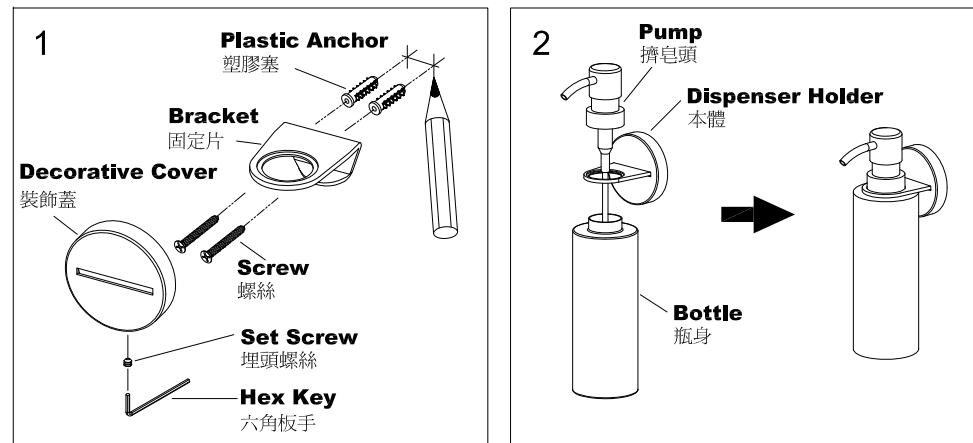

1. Select proper position for product and mark center of mounting hole on wall.
請先選取預定安裝的位置,並在牆壁上畫上預定鑽孔記號。
2. Using a 6mm drill-bit, drill the holes in marked position to a depth of 4cm. Insert the **Plastic Anchors** into the holes on the wall, put the **Screw(s)** through the **Bracket(s)**, then screw into the **Plastic Anchors**.
當安裝在水泥牆,使用1/4英寸鑽頭,鑽孔深度4公分,嵌入塑膠塞並使之齊平於牆面,將固定基座以螺絲鎖緊在牆上。
3. Use the **Hex Key** to loosen the **Set Screw** in the **Decorative Cover**. Slide the **Decorative Cover** over the **Bracket** and tighten **Set Screw** ensuring the orientation of the **Decorative Cover** is correct.
用隨附六角扳手先鬆開裝飾板下方的埋頭螺絲,使固定片能順利套進裝飾板後,再鎖緊下方的埋頭螺絲。
4. Assemble the Soap Dispenser as fig.2 shown.
將瓶身及擠皂頭結合於本體,完成安裝程序。

FIXING CONTENTS

組配件內容

